

## **St. Norbert Parish Cart Trails** **Collected by Jim Jerome**

This late 1800s survey of St. Norbert Parish (Manitoba) was collected and contributed by Metis researcher Jim Jerome. The document shows the river lots on both sides of the Red River and the cart trails which pass through the parish.

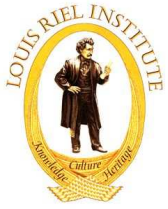

Compiled by Lawrence Barkwell  
Coordinator of Metis Heritage and History Research  
Louis Riel Institute

THIRD SECOND EDITION (CORRECTED)

PLAN OF  
TOWNSHIP N<sup>o</sup> 9

RANGE 3 EAST OF PRINCIPAL MERIDIAN

136

Scale, 40 Chains to an inch

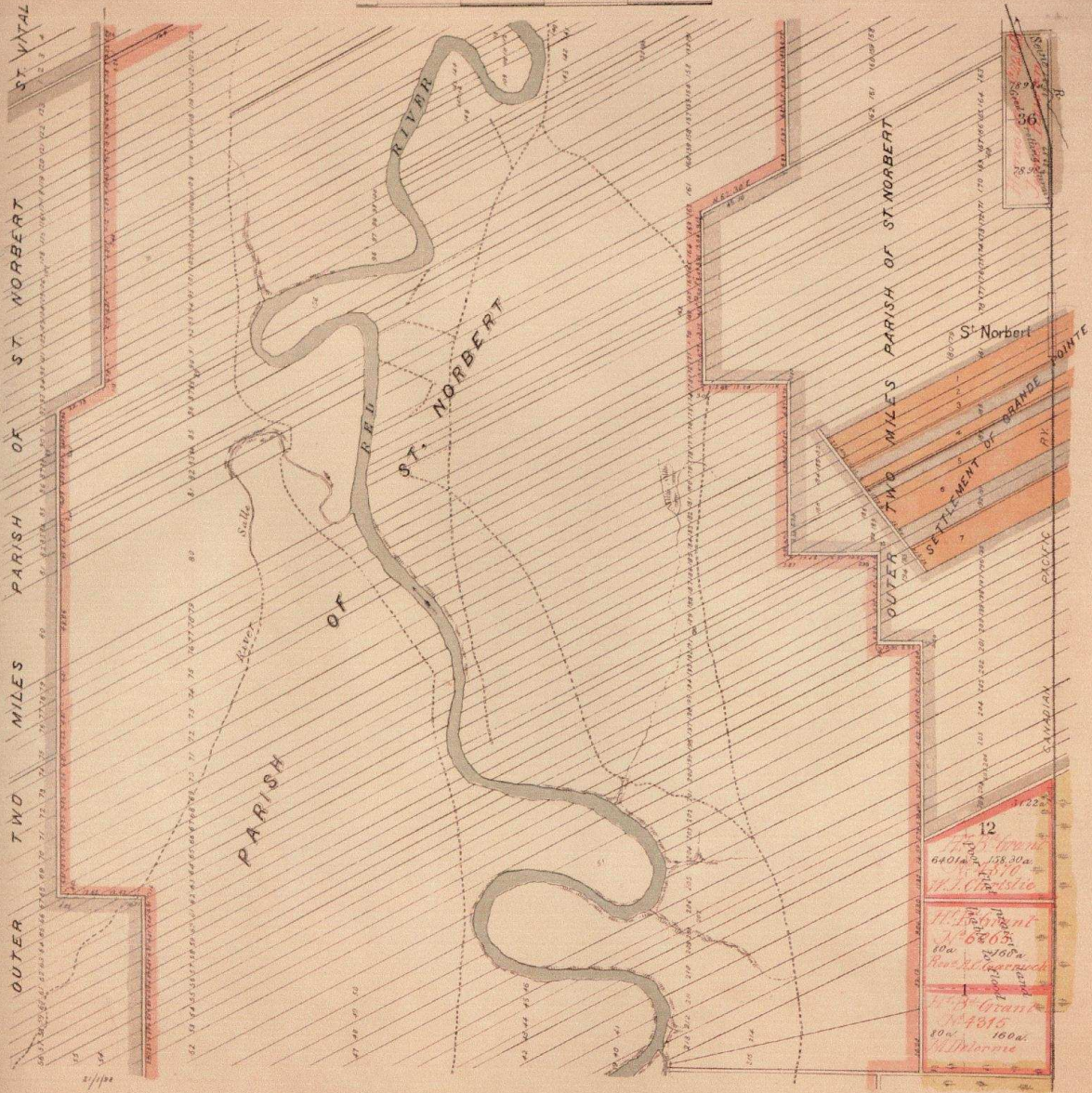

Compiled from confirmed surveys by

J.H. Lynch Staunton D.L.S. 1871

John Johnston " 1871

M.J. Charbonneau " 1884

A.F. Martin " 1874

G.M.C. Phillips " 1874

DEPARTMENT OF THE INTERIOR

TOPOGRAPHICAL SURVEYS BRANCH

Ottawa, January 5<sup>th</sup> 1898

Edeville

Surveyor-General

EXPLANATION OF COLORS:

Woods	Green	Scrub or Prairie and Woods	Dotted green	Water	Blue
Marshes	Yellow with small strokes of black	Hills or Slopes	Etching or Grey Shade		
Bruce (Burnt Woods)	Brown	Settler's Improvements	Pink		